

Forey Trust Land Auction – Tract 5

SW1/4 NE1/4 Section 31, West Bend Township, Palo Alto
County minus a building site



Gross acres: 35 m/l (to be surveyed)
Crop acres: 35.2
Real Estate Taxes: \$748 annually
CSR: 64.5 **CSR2:** 75.4
(soil map on back)

FSA Information

Cropland acres	35.2
Corn Base acres	18.6
Corn Direct / CC Yield	124 / 124
Soybean Base acres	16.2
Soybean Base acres	36 / 36



ACRE Co. Farm Real Estate
Spencer, Iowa
712-262-3529 theacreco.com



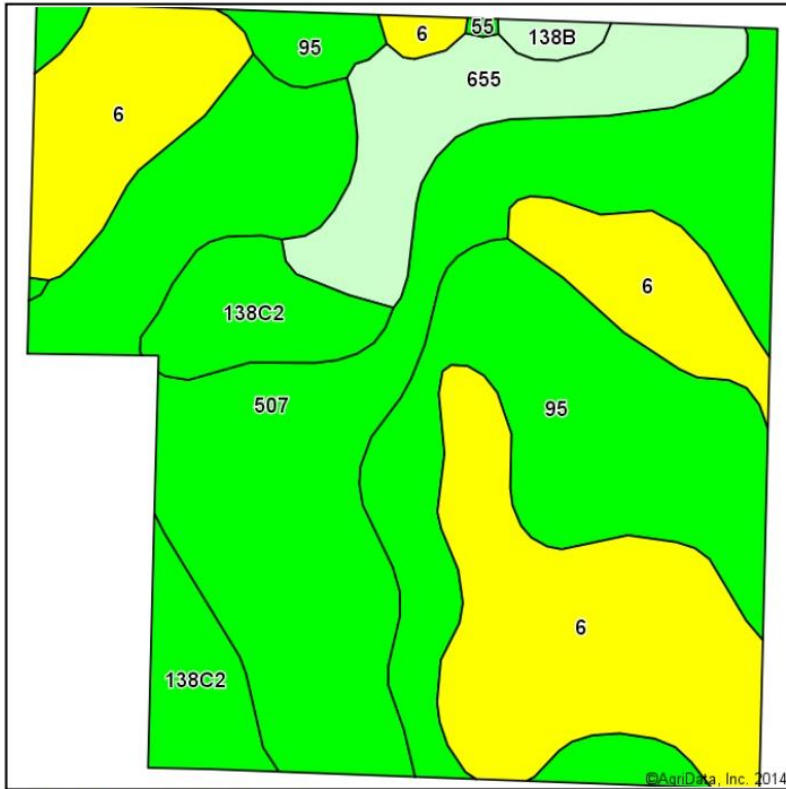

Soils data provided by USDA and NRCS.

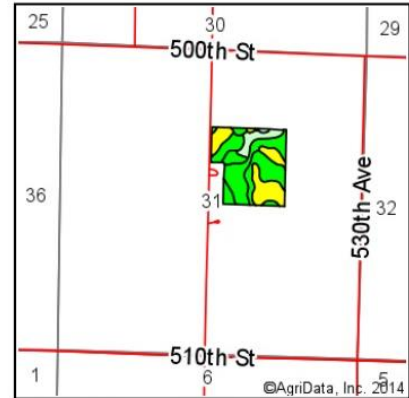

State: **Iowa**
 County: **Palo Alto**
 Location: **31-94N-31W**
 Township: **West Bend**
 Acres: **35.2**
 Date: **11/14/2014**



Area Symbol: IA147, Soil Area Version: 19

Code	Soil Description	Acres	Percent of field	**CSR2 Legend	Non-Irr Class	CSR2**	CSR
507	Canisteo silty clay loam, 0 to 2 percent slopes	11.95	33.9%		IIw	88	74
6	Okoboji silty clay loam, 0 to 1 percent slopes	9.65	27.4%		IIIw	55	54
95	Harps clay loam, 0 to 2 percent slopes	7.46	21.2%		IIw	72	59
655	Crippin loam, 0 to 3 percent slopes	3.09	8.8%		I	91	79
138C2	Clarion loam, 6 to 10 percent slopes, moderately eroded	2.81	8.0%		IIIe	83	58
138B	Clarion loam, 2 to 6 percent slopes	0.24	0.7%		Ile	90	76
Weighted Average						75.4	64.5